

153 South Jefferson Street
 Spokane, WA 99201
 509 838.4511 | fax 509 838.4605
 www.bernardowills.com

Project:	NEWTECH Skill Center Phase 2 Modernization Spokane Public Schools 4141 North Regal Street Spokane, WA 99207	Date:	October 20, 2015
BWA No:	14-370	Addendum No:	Three

This Addendum forms a part of the Contract Documents and modifies the original Bidding Documents dated October 1, 2015, as noted below. This Addendum shall become a part of the Contract Documents to the same extent as though it had been written into the body thereof and bound therein. This Addendum is applicable to the items affected and all bidders are held responsible for the contents herein. Please acknowledge receipt of this Addendum in the space provided on the Bid Form; failure to do so may subject the Bidder to disqualification.

This Addendum consists of a total of 5 pages and 10 drawings.

A. CHANGES TO PRIOR ADDENDUM

Addendum 1:

1. Changes to Drawings: Item 6. – Finish Floor Plans (sheets A2.41, A2.42 & A2.43):
 - a. Finish Floor Plan Legend – Carpet; delete reference to ~~O.F.C.L.~~. Carpet is to be provided in the base bid under the general contract.
 - b. Add a General Floor Finish Note: A. Where new floor finish system is shown or noted, remove existing floor finish system down to bare substrate in preparation for installation of new floor finish system.

Addendum 2:

2. Changes to Drawings: Item 13. – Drawing A4.03 – Wall Sections (Addendum 2 drawing A2.16):
 - a. Wall Section #1: Revise detail callout at the top & bottom of the window to 10/A8.10.
 - b. Wall Section #4: Revise detail callout at the top & bottom of the window to 10/A8.10.
 - c. Drawing Titleblock: Revise to drawing reference read: "RE: A4.03 WALL SECTIONS."
3. Changes to Drawings: Item 26. – Drawing A7.02 – Room Finish Schedule (Addendum 2 drawing A2.22): Room W100 - Revise wall finish material callout to Plywood (PWD) on all walls. Add note that on the restroom and custodial walls in W100, the wall finish material changes to GWB above 8'-0" AFF. Clarification: Finish on all walls (PWD & GWB) in W100 remains PNT-1.
4. Changes to Drawings: Item 37. – Structural Details / Mezzanine Framing Plan (Addendum 2 drawing S2.36): Revise detail callout on the exterior 8-inch wall running east-west (north wall) to read 14/S4.11.
5. Changes to Drawings: Item 39. – Structural Details / Mezzanine Ceiling Framing Plan (Addendum 2 drawing S2.42):
 - a. Revise detail callout on the exterior 8-inch wall running east-west (north wall) to read 14/S4.11.
 - b. Delete reference to ~~1-1/8" Plywood Shtg on S600 joists at 12 inches on center.~~
 - c. Note ~~MEZZ FIN FLR +8-8"~~ should be MEZZ FIN CLG SEE ARCH. SECTIONS.

B. CHANGES TO BIDDING REQUIREMENTS

1. None.

C. CHANGES TO AGREEMENT AND OTHER CONTRACT FORMS

1. None

D. CHANGES TO THE CONDITIONS OF THE CONTRACT

1. General Conditions A201-2007 Revised: Paragraph 3.4.3.1: Delete reference to ~~background checks~~ from the first sentence.

E. CHANGES TO SPECIFICATIONS

Volume 3:

1. Section 238239 – Electric Heaters
 - a. 2.01-H: Revise paragraph #9 reference to room thermostat to duct stat as follows:
 9. SCR Controller complete with back up contactors and factory supplied thermostats that will modulate the heat output of the heater from the 0 to 100% as required by the ~~room~~ duct thermostat.

F. CHANGES TO DRAWINGS

1. Drawing A2.13 – FLOOR PLAN - NORTH: Add interior elevation callouts in Rooms 123, 127, 131, 131B, 139 and Vestibule 100B. See attached drawings A3.06 and A3.07.
2. Drawing A2.30 / ROOF PLAN:
 - a. Keyed Notes: Add the following instructions after Keynote 1:
 - 1) Wash the surface of the glazing panel with mild dish detergent, soft brush and water rinse. Do not use a pressure washer.
 - 2) Sand the surface lightly to reduce the fibers that may have exposed themselves.
 - 3) Wash and rinse a second time and let dry.
 - 4) Apply a clear coat over the surface of the glazing panel. Sherman Williams Sher-Clear 1K Acrylic Clear Coat. or approved equal.
1. Drawing A5.11 / INTERIOR ELEVATIONS:
 - a. Elevations, Detail 3 – Add Notes 2, 13, & 18. See attached drawing A3.08.
2. Drawing A5.12 / INTERIOR ELEVATIONS:
 - a. Elevations, Details 3, 4, & 5 – Add Note 18. See attached drawing A3.09 for typical west corridor door alcove.
3. Drawing A5.14 / INTERIOR ELEVATIONS:
 - a. Elevations, Detail 2, 3, 4: Clarification: MDF panels are to be included in base bid.
 - b. Elevations General Notes & Keyed Notes – Add Notes. See attached drawing A3.01
 - c. Revise Detail 1-6. See attached drawing A3.02.
 - d. Revise Detail 7-8. See attached drawing A3.03.
 - e. Revise Detail 9-11. See attached drawing A3.04.
4. Drawing A7.02 / ROOM FINISH SCHEDULE AND BUILDING ASSEMBLY:
 - a. Finish Legend – Revise Walk Off Mat Installation to read: “Per Specifications”.
5. Drawing A8.21 / INTERIOR DETAILS:
 - a. Add Detail 17. See attached drawing A3.05.
6. Sheet M2.14 – Floor Plan – Industrial Manufacturing Training Building – HVAC
 - a. Shift electric duct heater to the north in order to provide the required 36” clearance. This also requires shifting of the mixed air duct to the north and changing to an eccentric transition to the return grille. See attached clarification drawing MC-11.

PRIOR APPROVALS

The following products may be bid, provided the manufacturer and/or suppliers meet all the requirements of the originally specified product. It shall be the initiator's responsibility to ensure the proposed substitution is equal in every respect to the originally specified product including, but not limited to size, weight, finish, clearances, durability, maintenance, operation, electrical requirements, warranty, etc.

<u>Section</u>	<u>Manufacturer</u>	<u>Type</u>
----------------	---------------------	-------------

Volume 2

07 1900	Prosoco	Weather Seal Blok-Guard & Graffiti Control 15
12 3653	Durcon	Chemical Resistant Solid Phenolic Compact – Laboratory Work Surface

Volume 3

23 8219	JCI	Fan Coils
---------	-----	-----------

H. ATTACHMENTS

1. None.

I. BIDDER QUESTIONS WITH RESPONSES

1. *Carpet is noted at OFCI, please confirm carpet material is provided by the Owner.*

Response: Carpet material is to be provided under the general contract. See Addendum item above.

2. *General Conditions paragraph 3.4.3.1 mentions Background Checks for contractor's employees. Please confirm if background checks will be required for all personnel onsite, and with which agency?*

Response: Background checks are not required. See Addendum item above.

3. *What is the anticipated start date for the project? There is no timeframe listed, only Substantial Completion Date. Is there a calendar day timeframe for construction? If not, what can we expect start date to be?*

Response: Refer to the Proposed Construction Phasing Schedule on sheet A0.03. NTP is anticipated to be issued on or after November 19th.

4. *Where are the 12 GA Z Girts and C Girts shown on sheet S4.10 at the Industrial Manufacturing Training Building located in the specifications?*

Response: Provide girts in the gauge and size noted.

5. *Per the finish schedule on sheet A7.02, the floor finish for room W100 in the industrial building is to be CONC. We noticed at the walk-thru that this slab is covered in oil. Please confirm that we are not to address the oil spill in our bid?*

Response: Prep the existing concrete slab per the sealer manufacturer's recommendations.

6. *The MDF panels shown on the interior elevations 2,3,4 on A5.14, are they to be in the base bid or alternate #3?*

Response: MDF panels in the vestibules are in the base bid.

7. *Addendum #2 shows updates for sheet A2.14, however it's listed as A2.13?*

Response: The Addendum #2 drawing number is A2.13 as included in the Addendum. The sheet it applies to is A2.14.

8. *Addendum #2 references revisions to multiple notes on sheet A5.14, however there Keyed Notes and interior elevations do not show any of the numbers listed per addendum #2 page 5, 17.a thru 17.k. Please provide an updated elevation sheet?*

Response: Refer to Addendum item above.

9. *The Walk-Off Mat in the 124813 specs is listed as a broadloom under part 2.1 Manufacturer and under 3.2 Installation it notes to use a surface-type installation. However, in the Finish Legend on A7.02 it notes the Installation Method for WOM-1 as ¼ Turn which is for Carpet Tile. Is the Walk-Off Mat supposed to be Tile or Broadloom and is it supposed to be glue down or surface installation?*

Response: Walk-Off Mat is to provided per the specifications. Refer to Addendum item above.

10. *The VT-1 thru VT-4 listed in the specs and on the Finish Legend is a 24x24 Tile. However, on the patterns provided in the Finish Plan issued with Addendum #1, the tiles are 20x20. Is there an updated pattern that uses the 24x24 Tiles spec'd? Or are we supposed to cut down the tiles to 20x20?*

Response: Use the specified tile size. Pattern to be adjusted accordingly. Quantity of accent tiles to remain as shown.

11. *Please provide an updated plan A2.13 showing interior elevations for casework at rooms 123, 127, 131, 131B, 133, and 139; also Vest 100B showing MDF panels.*

Response: Refer to Addendum item above.

12. *In reviewing again the abatement requirements for the Newtech project, including Addendum #2, I am anticipating the following scope of work will be included in our bid;*
- Removal of the lighting ballast and handling of any lead containing painted items (which will be completed by the demo contractor) – per Section 02 85 00, and 02 90 00 (included at the end of volume 4).*
 - Removal of the roofing underlayment which will be part of the roofing demo completed by the roofing subcontractor (who will have the appropriate certifications).*
 - It does not appear that specific requirements for abatement of any other materials are required.*

So, my question is. .. we will not have an "abatement subcontractor" ...so would we put n/a on the bid form under the listing for abatement subcontractor?

Response: List any companies doing abatement work on the form provided. Refer to the section titled "Proven Regulated ACM Materials" on page S-2 of the Good Faith Regulated & Hazardous Material Assessment for a listing of ACM materials that may be impacted by the project.

13. *In Addendum #2, there is a Sheet A2.16 showing a revision to the window head/sill as 10/A8.13; however this detail is a handrail at metal framed wall. Also, on the side of the A2.16 sheet it notes RE: A6.01; should it read RE: A4.03?*

Response: Detail callout noted should read 10/A8.10. Sheet reference should read A4.03. See Addendum item above.

14. *What is the top of footing elevation (or depth of the footing) which is being added via detail 2/AS5.10?*



Response: Refer to the dimensions on the detail (2/S5.10), the bottom of the existing pre-cast wall is approximately 2'-6" below floor elevation. The bottom of the new grade beam is 6 inches above the bottom of the existing wall.

15. *In addition to the Lay-Down areas on Sheet A0.03, are there other areas available for dumpsters and equipment related to the roofing work?*

Response: There are additional areas on the north end of the building and small areas (12'-16') along the west side that could be used for dumpsters and equipment as long as they are fenced off and all doors (overhead and personnel) are kept available for exiting and school use.

END OF ADDENDUM

ELEVATIONS GENERAL NOTES:

1. SEE ELECTRICAL DRAWINGS FOR POWER AND DATA LOCATIONS.
2. ALL DATA/POWER/PHONE OUTLETS TO BE 18" A.F.F. UNLESS NOTED OTHERWISE.
3. PROVIDE BACKING AT ALL UPPER CABINET LOCATIONS.
4. SEE 10/A8.21 FOR TYPICAL COUNTER SUPPORT. 
5. SEE 1/A5.10 FOR MISC. EQUIPMENT AND TOILET ACCESSORIES HEIGHTS.
6. PROVIDE 1/4" CHAMFER AT ALL MDF EDGES, TYP. - PAINT.
7. ALL PLASTIC LAMINATE COUNTERS TO HAVE T-MOLD EDGES, TYP. ARCHITECT TO SELECT COLOR FROM MANUFACTURER'S STANDARD COLORS.
8. PROVIDES EDGEBANDING ON ALL PLASTIC LAMINATE CASEWORK/PANEL EDGES , TYP.
9. ALL MECHANICAL GRILLES/DIFFUSERS TO BE PAINTED TO MATCH CEILING, TYP.
10. ALL EXPOSED STRUCTURE, MECHANICAL DUCTS, CABLES, PIPES, ETC. TO BE PAINTED (PNT-1)
11. SEE SHEET A7.01 FOR DOOR AND WINDOW TYPES. 
12. ALL HOLLOW METAL FRAMES TO BE PAINTED PNT-5.

ELEVATIONS KEYED NOTES:

- 1 CURVED GWB WALL, PNT.
- 2 MDF, PNT
- 3 GWB, PNT
- 4 DOOR & FRAME - SEE SCHEDULE
- 5 WINDOW - SEE TYPES
- 6 RUBBER BASE, TYP.
- 7 2" SURFACE MOUNT STAINLESS STEEL END WALL PROTECTORS. PROVIDE ON DOOR FRAME TYP.
- 8 GWB SOFFIT - PNT
- 9 BI-PARTING CURTAIN ON WALL MOUNTED STEEL WALK/DRAW TRACK @ 8'-6" A.F.F.
- 10 MDF VALANCE - COORDINATE DEPTH IN FIELD.
- 11 NOT USED
- 12 2"W STAINLESS STEEL CORNERGUARD
- 13 FRY REGLET "X" MOLDING - SEE DETAIL 10/A8.20.
- 14 FRY REGLET "J" MOLDING- SEE DETAIL 11/A8.20.
- 15 1/4" CHAMFER @ MDF EDGE - PNT.
- 16 NOT USED 
- 17 TACKBOARD CASE
- 18 WRAP MDF WALL PANELS AROUND CORNER
- 19 NOT USED
- 20 4" MAPLE CHAIR RAIL @ 36" A.F.F. U.O.N. STAIN TO MATCH PL-1.
- 21 TE CABINET - SEE INTERIOR DETAILS
- 22 PROJECTION SCREEN - PROVIDE MDF BACKERBOARD ON WALL FOR SCREEN MOUNTING - PNT TO MATCH WALL, TYP. 
- 23 16'L MARKERBOARD
- 24 ADJUSTABLE P-LAM SHELVEING ON STANDARDS
- 25 PROVIDE POWER/DATA FOR POS
- 26 REMOVABLE P-LAM ACCESS PANELS

Addendum #3

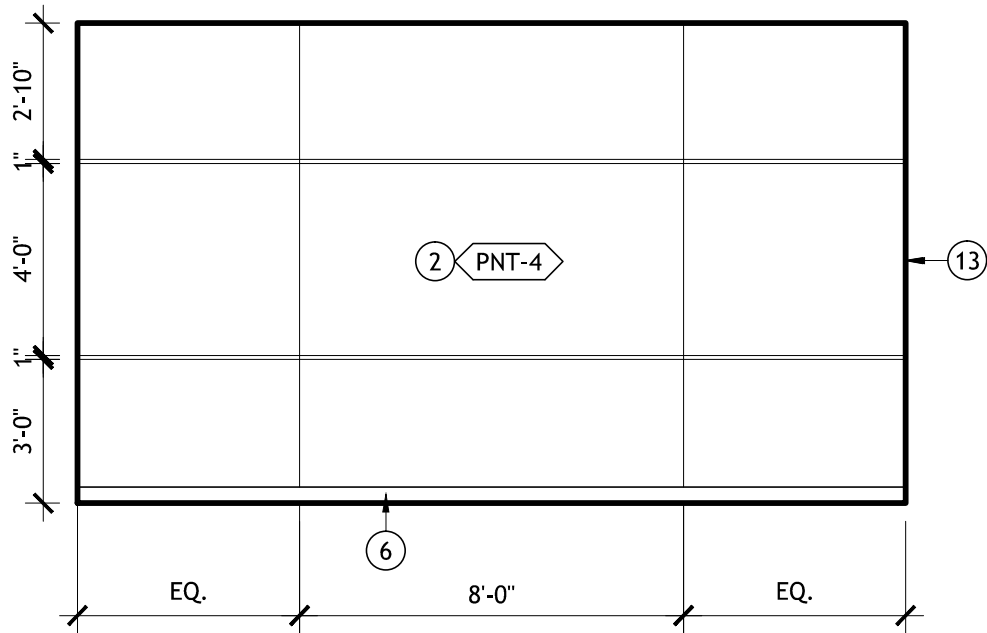

1 HALL 100 (ALTERNATE #3)

SCALE: 1/4" = 1'-0"

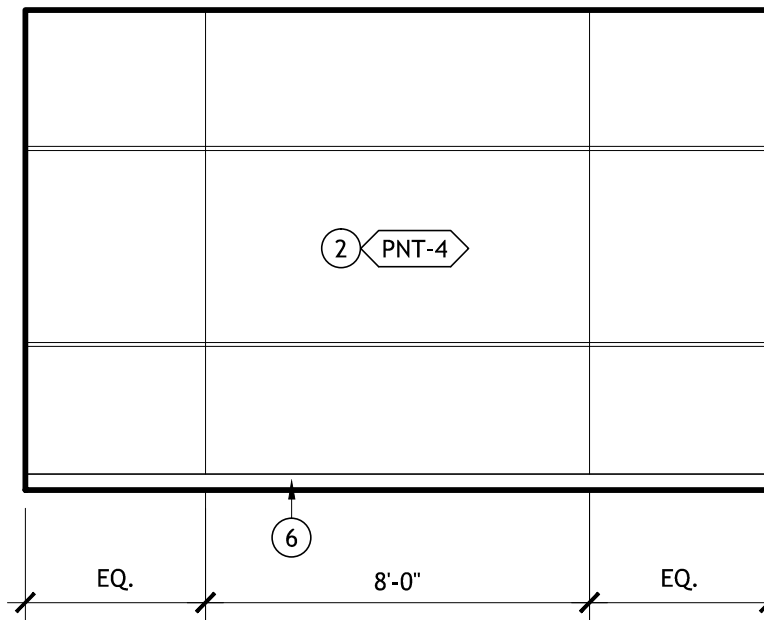

2 VESTIBULE 100A

SCALE: 1/4" = 1'-0"

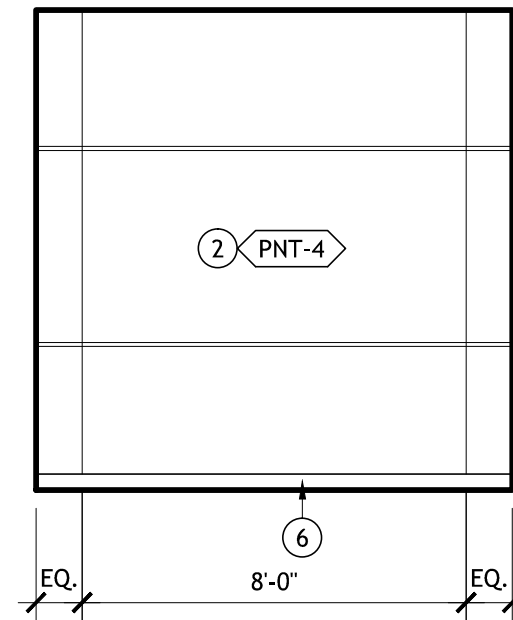

3 VESTIBULE 100B

SCALE: 1/4" = 1'-0"

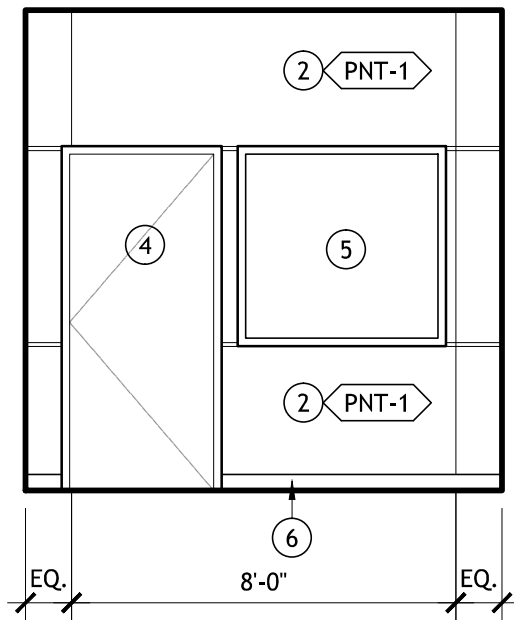

4 VESTIBULE 100B

SCALE: 1/4" = 1'-0"

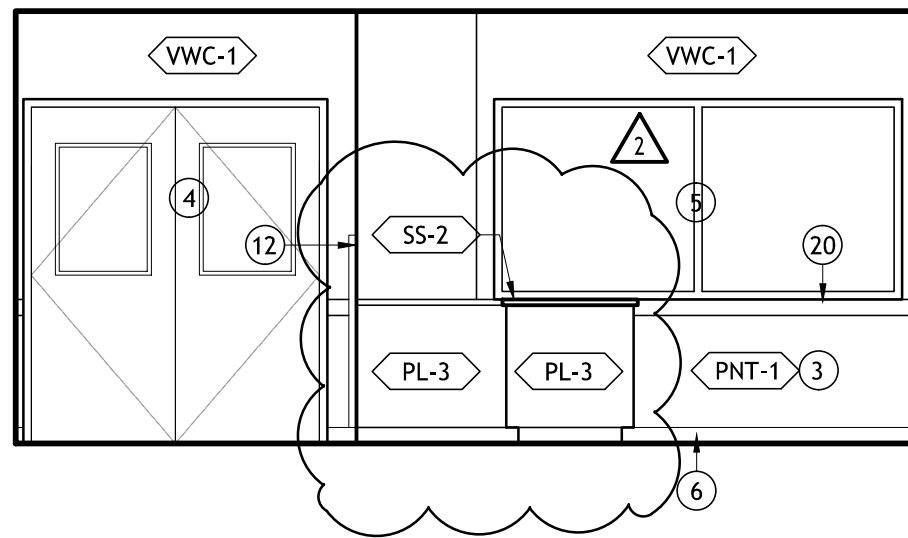

5 DINING/CLASSROOM 107

SCALE: 1/4" = 1'-0"

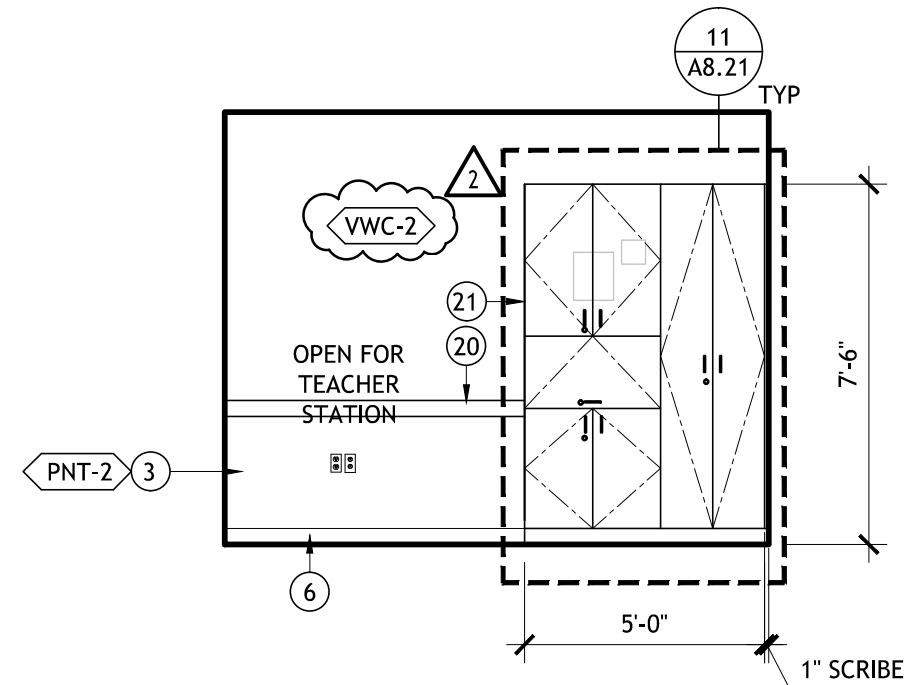

6 DINING/CLASSROOM 107

SCALE: 1/4" = 1'-0"

TE CABINET:

PL-1 Addendum #3

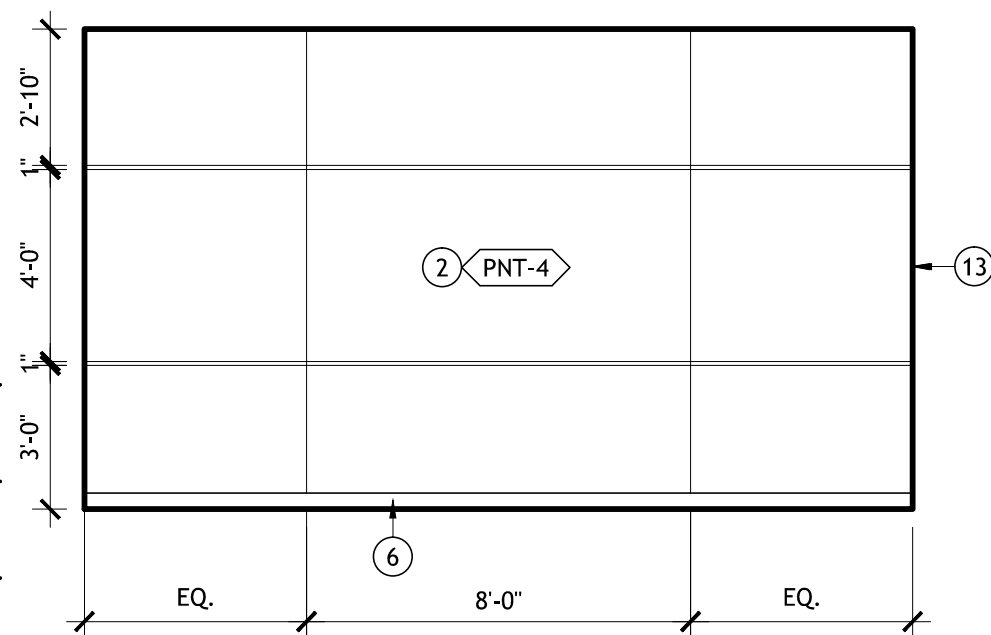

1	HALL 100 (ALTERNATE #3)
---	-------------------------

SCALE: 1/4" = 1'-0"

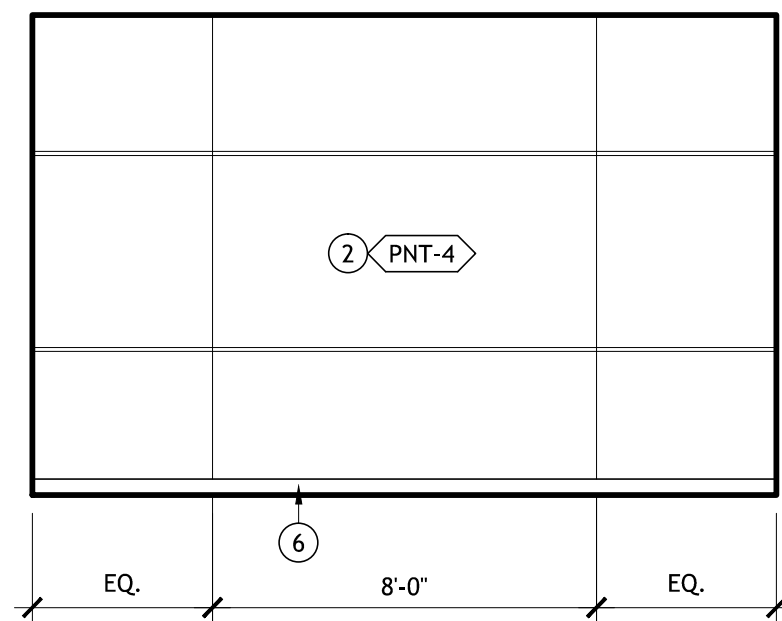

2 VESTIBULE 100A

SCALE: 1/4" = 1'-0"

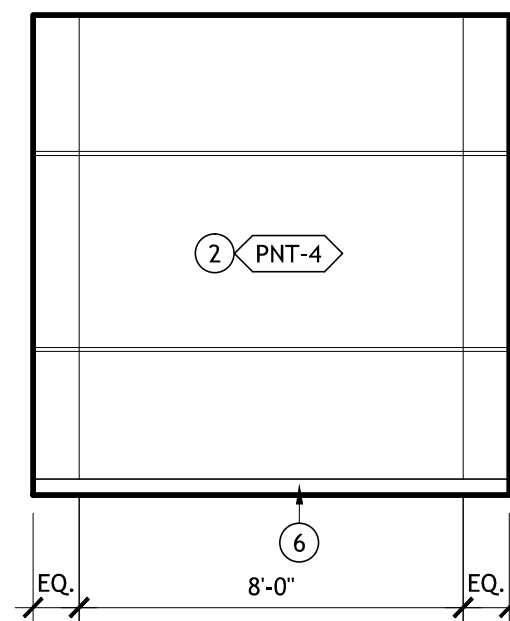

3 VESTIBULE 100B

SCALE: 1/4" = 1'-0"

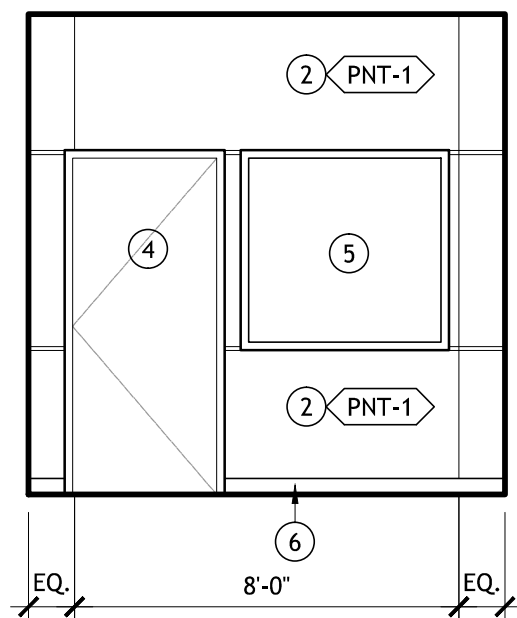

4 VESTIBULE 100B

SCALE: 1/4" = 1'-0"

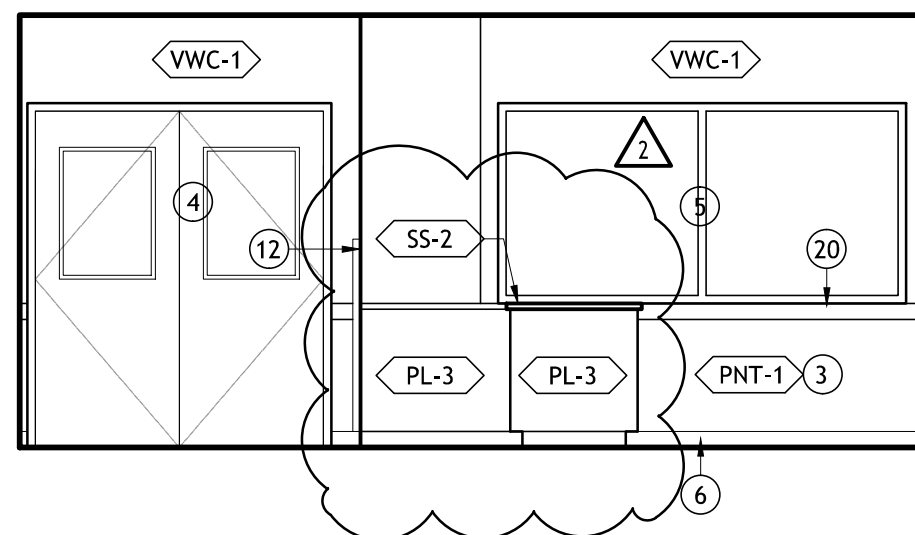

5 DINING/CLASSROOM 107

SCALE: $1/4" = 1'-0"$

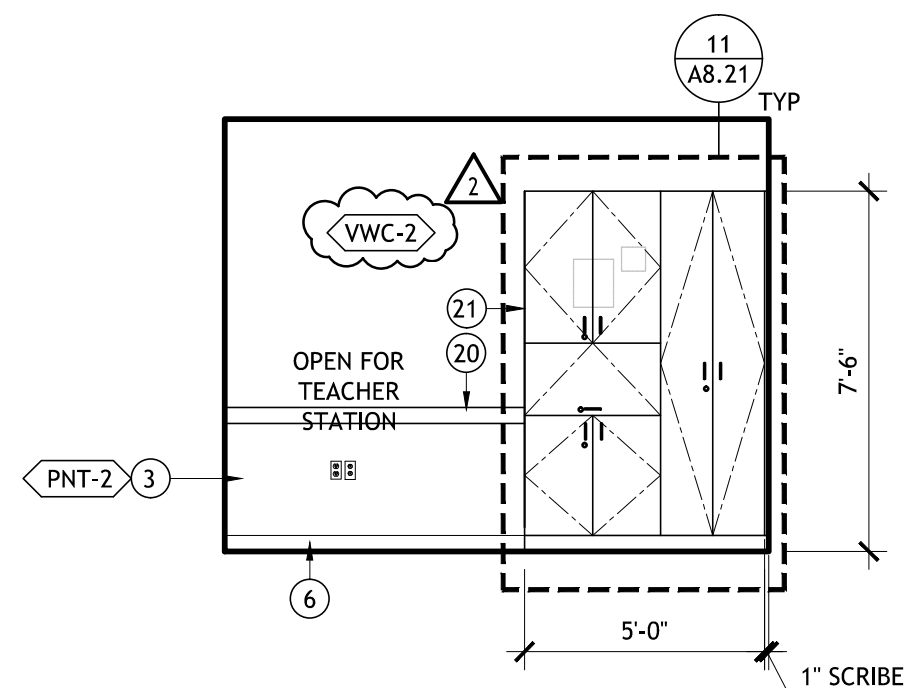

6 DINING/CLASSROOM 107

SCALE: 1/4" = 1'-0"

TE CABINET:

~~PL-1 Addendum #3~~

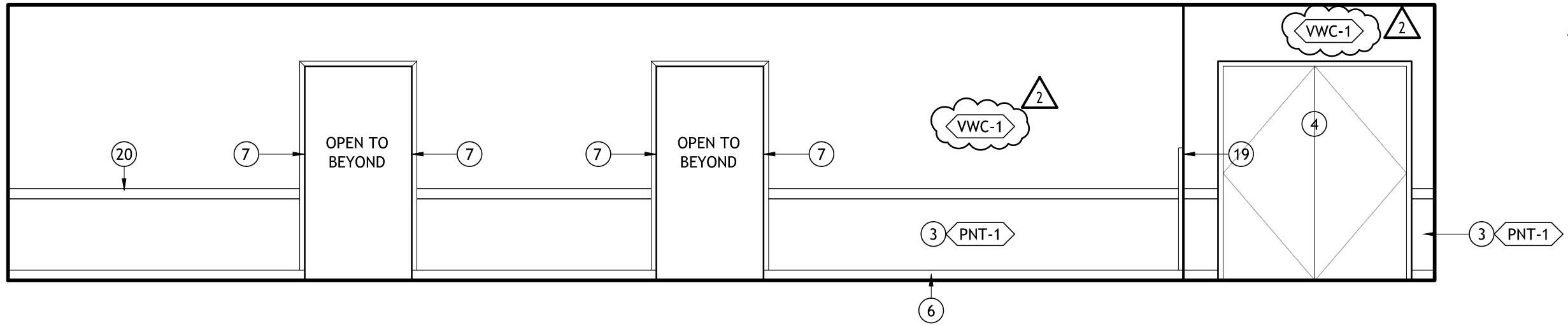

9 DINING 107

SCALE: 1/4" = 1'-0"

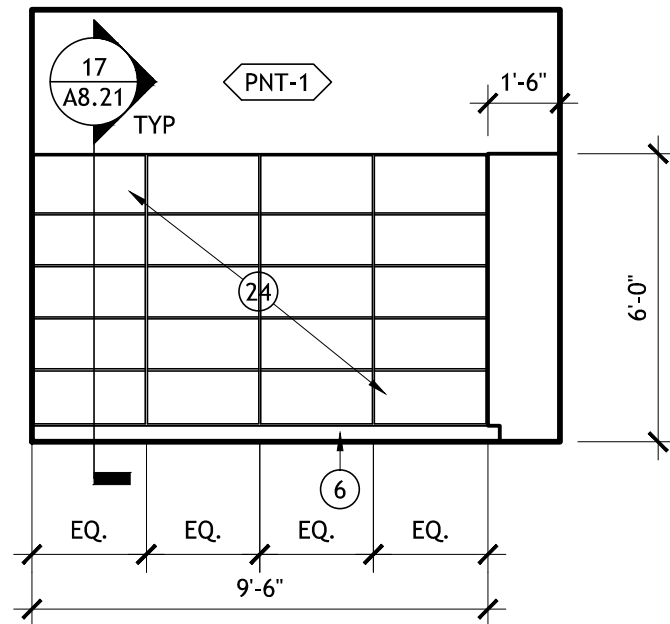

10 STORAGE 107A

SCALE: 1/4" = 1'-0"

CABINETS/OPEN CABINET INTERIOR: PL-1

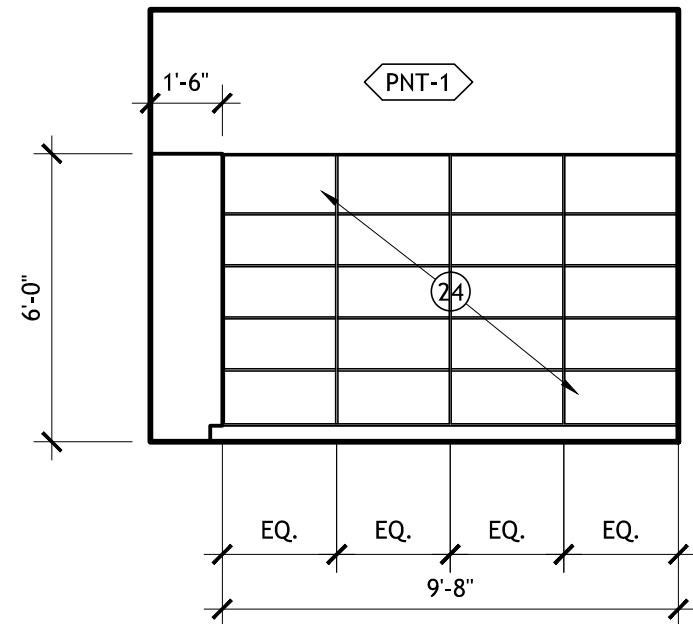

11 STORAGE 107A

SCALE: 1/4" = 1'-0"

CABINETS/OPEN CABINET INTERIOR: PL-1

3

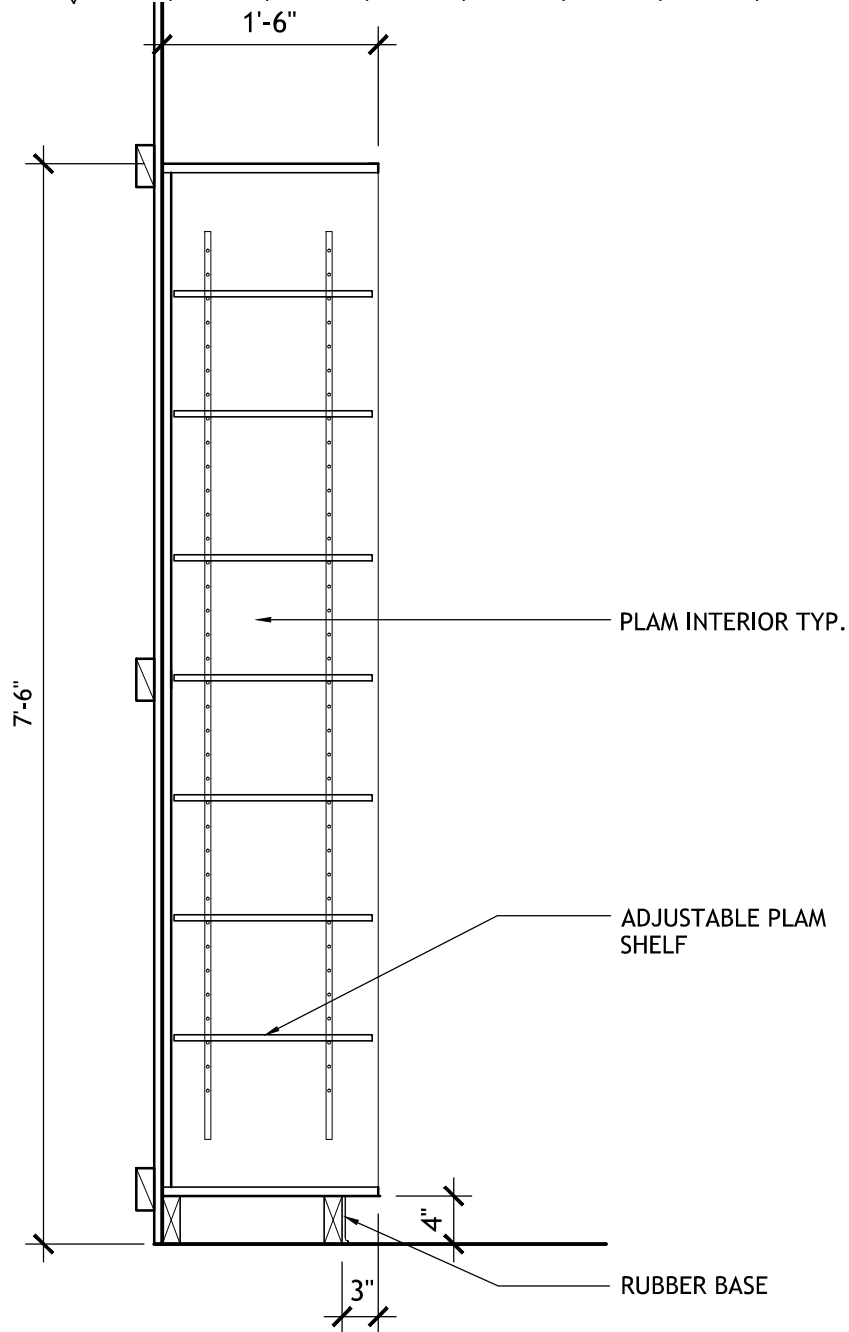

17 STORAGE CABINET

SCALE: 3/4" = 1'-0"

Addendum #3

B W A BERNARDO WILLS
ARCHITECTS PC

153 SOUTH JEFFERSON

SPOKANE WASHINGTON 99201

509.838.4511

FAX 509.838.4605

COPYRIGHT BERNARDO WILLS ARCHITECTS, PC 2015

NEWTECH Skill Center
Phase 2 Modernization

Spokane Public Schools
4141 North Regal Street
Spokane, WA 99207

STORAGE CABINET RM 107A
RE: SHEET A8.21, DETAIL 17

Project No: 14-370
Drawn by: MMW
Date: 10/20/2015

A3.05

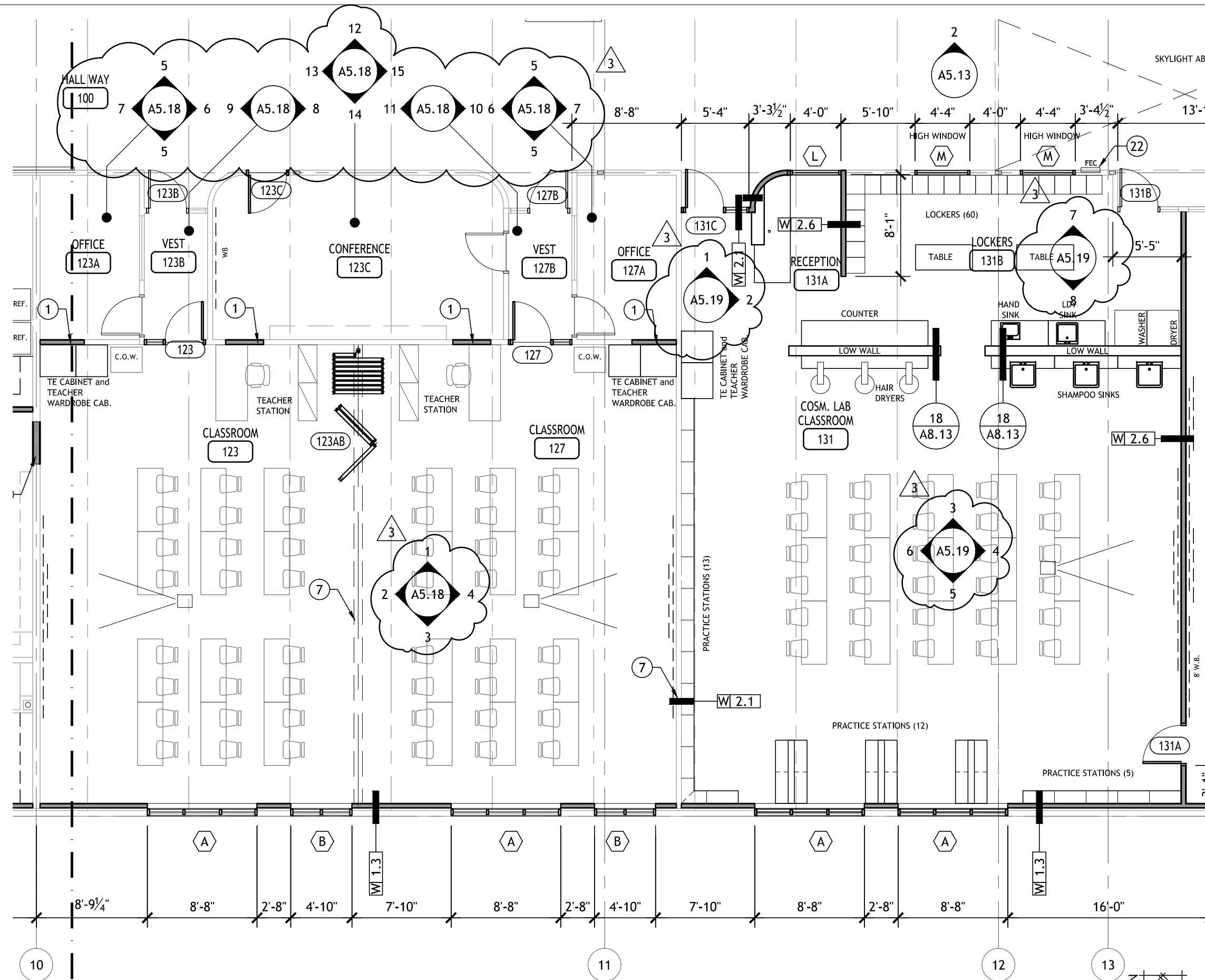

FLOOR PLAN - PHASE 2 - NORTH

SCALE: 1/8" = 1'-0"

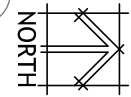

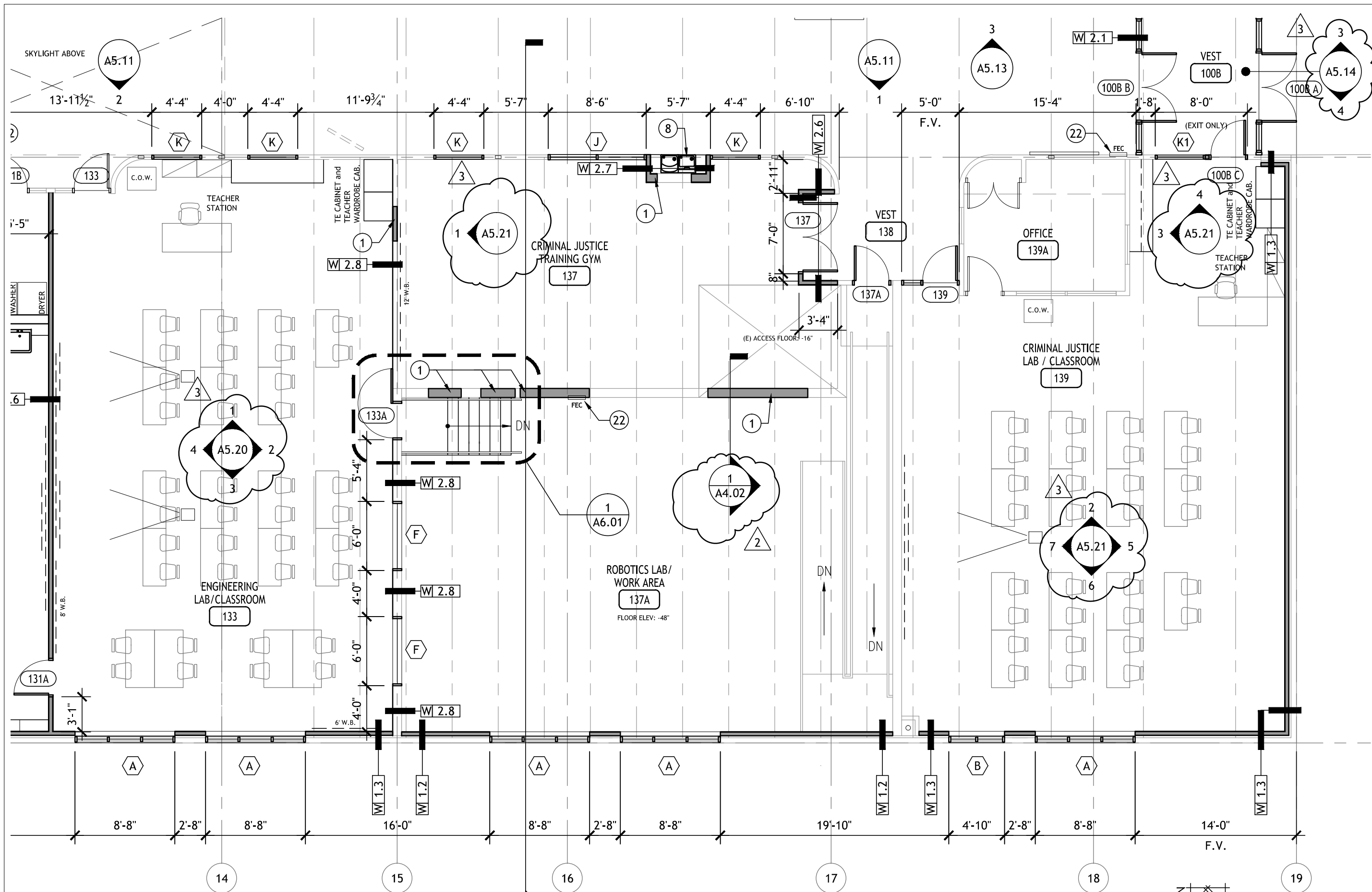

FLOOR PLAN - PHASE 2 - NORTH

SCALE: 1/8" = 1'-0"

153 SOUTH JEFFERSON SPOKANE WASHINGTON 99201 509.838.4511 509.838.4605 WWW.BERNARDOWILLS.COM COPYRIGHT BERNARDO WILLS ARCHITECTS PC 2015

B W A BERNARDO WILLS ARCHITECTS PC

NEWTECH Skill Center
Phase 2 Modernization
Spokane Public Schools
4141 North Regal Street
Spokane, WA 99207

Project No: 14-370
Drawn by:
Date: 10/20/2015

DETAILS SYMBOL
RE: A2.13 FLOOR PLAN - NORTH

A3.07

Addendum #3

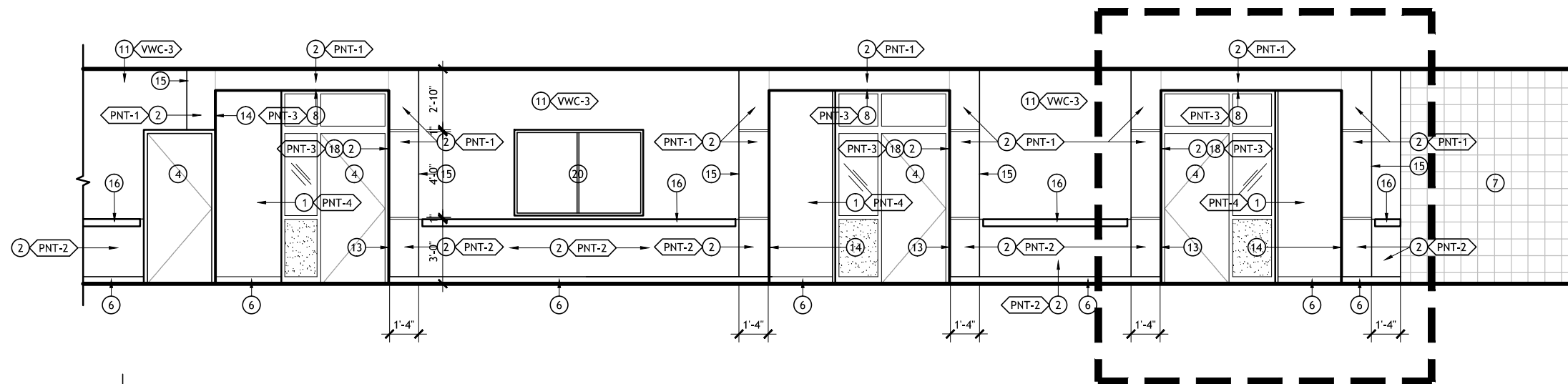

3 HALL 100 (ALTERNATE #3)

SCALE: NTS

3 ENLARGED HALL 100 (ALTERNATE #3)

SCALE: 1/4" = 1'-0"

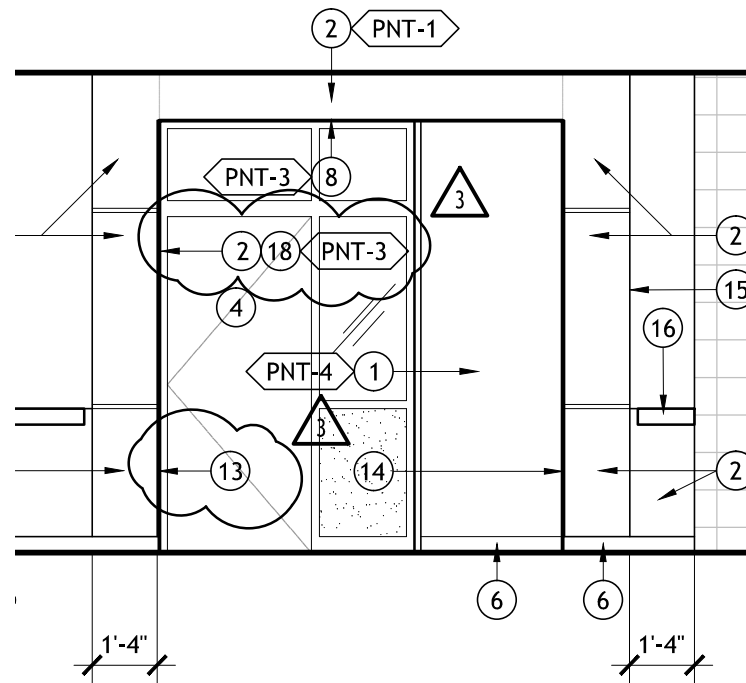

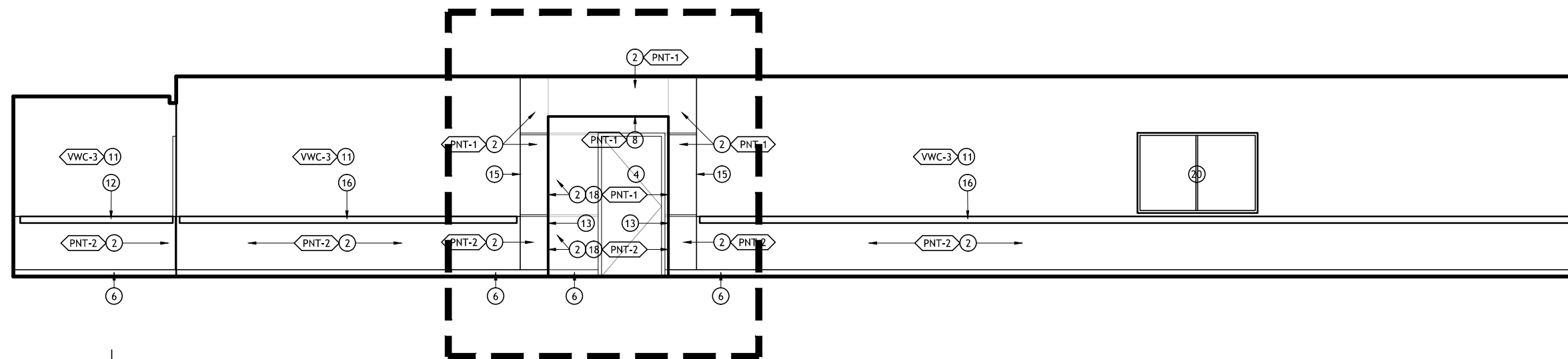

3 HALL 100 (ALTERNATE #3)

SCALE: NTS

ENLARGED HALL 100 DOOR ALCOVE, TYP. (ALTERNATE #3)

SCALE: 1/4" = 1'-0"

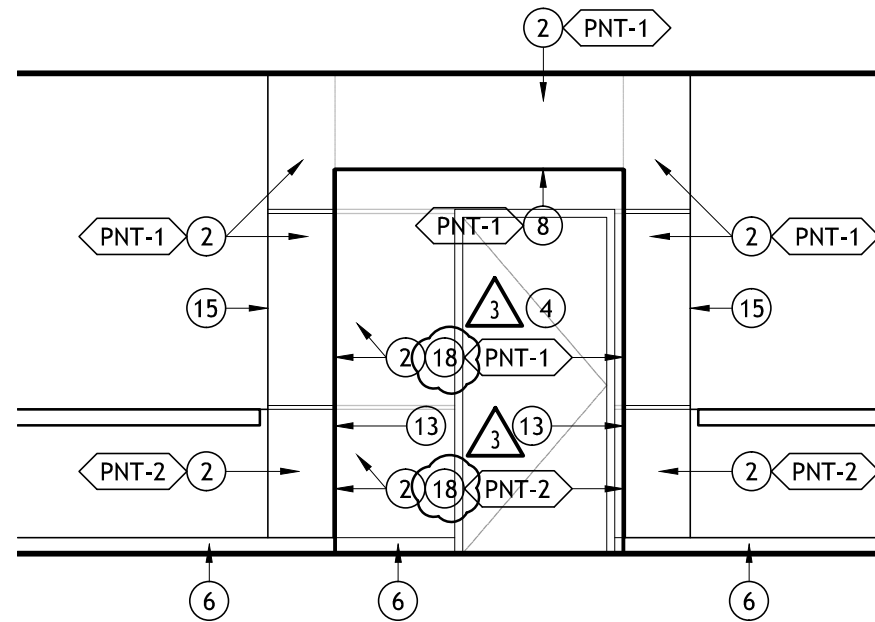

Addendum #3

